

# IGLO Energy Classic Expansion Joint Field Assembly Instructions

## Mullion Preparation:

1. Apply sealant to the end cap and install it on to the top and bottom of the mullion.

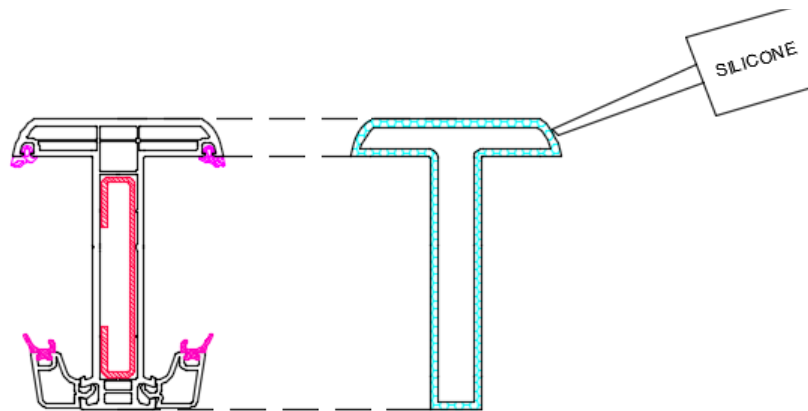

2. Temporarily install both windows and the spacers, maintaining a minimum gap of 2" between the windows.

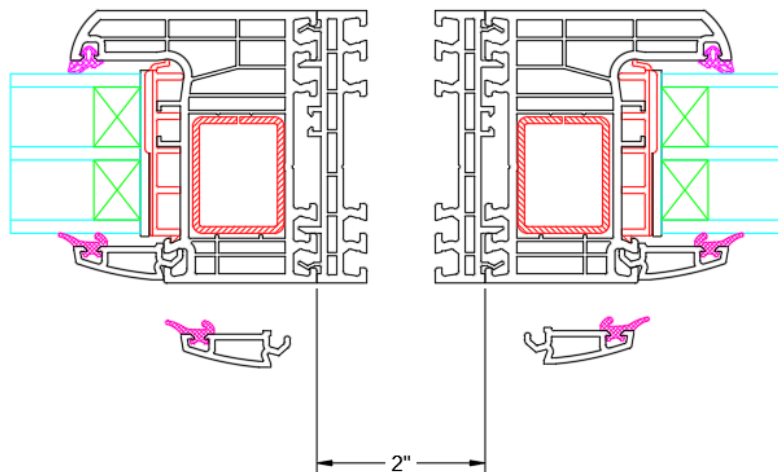

3. Place the mullion between the windows and adjust the left and right windows to maintain proper spacing between window frames and rough opening. (The gap between the mullion and each window frame can be 0" – 5/8".)

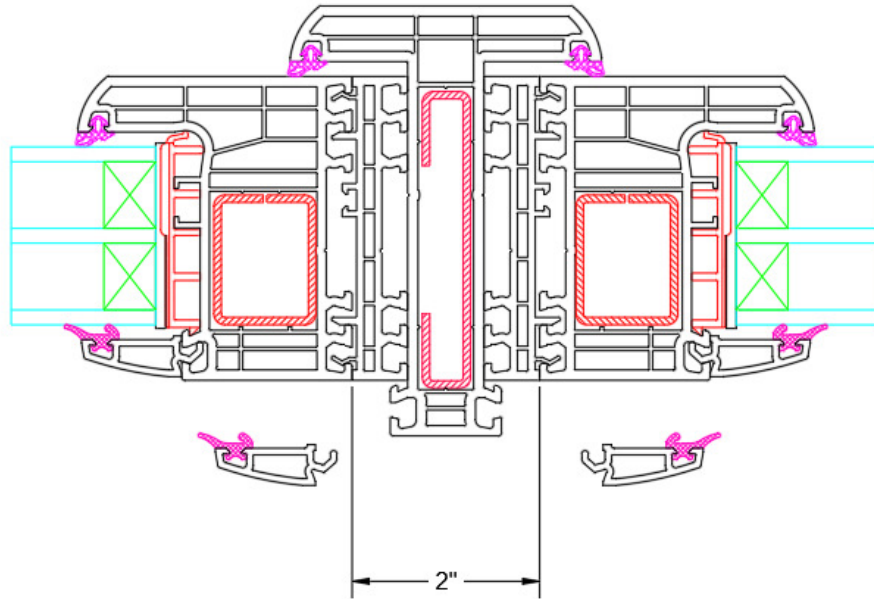

4. Finish aligning and installing the window. Insert snap-in glaze beads into the mullion to secure the windows in place. No fasteners are required.

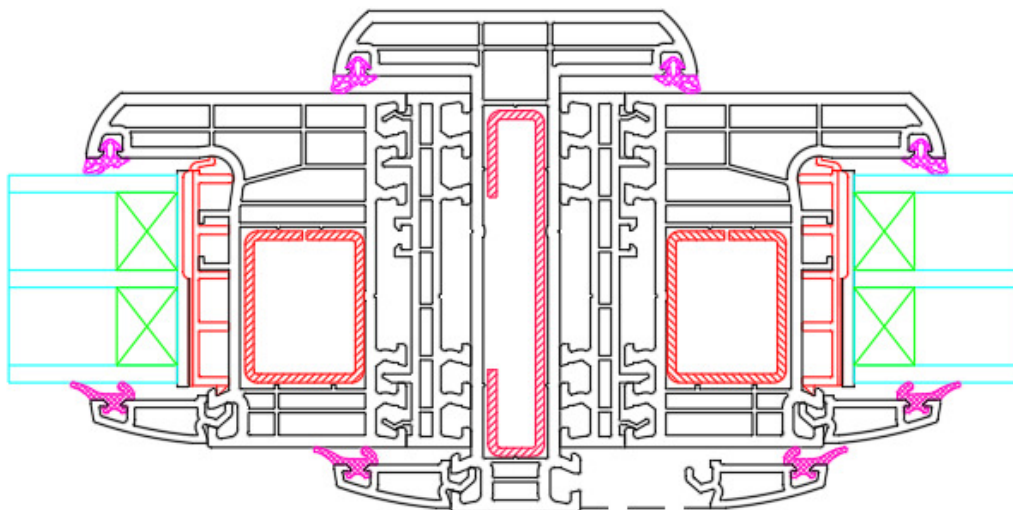

5. Tap the glaze bead into place with a 12 ounce double-face soft hammer (available at Home Depot, store SKU: 806699).



6. This assembly does not require fasteners or sealants. However, please check with your water proofing consultant regarding project specific water proofing guidelines.